

Assembly Instructions

--- Outward fold

--- Inward fold

✗ Cut away parts

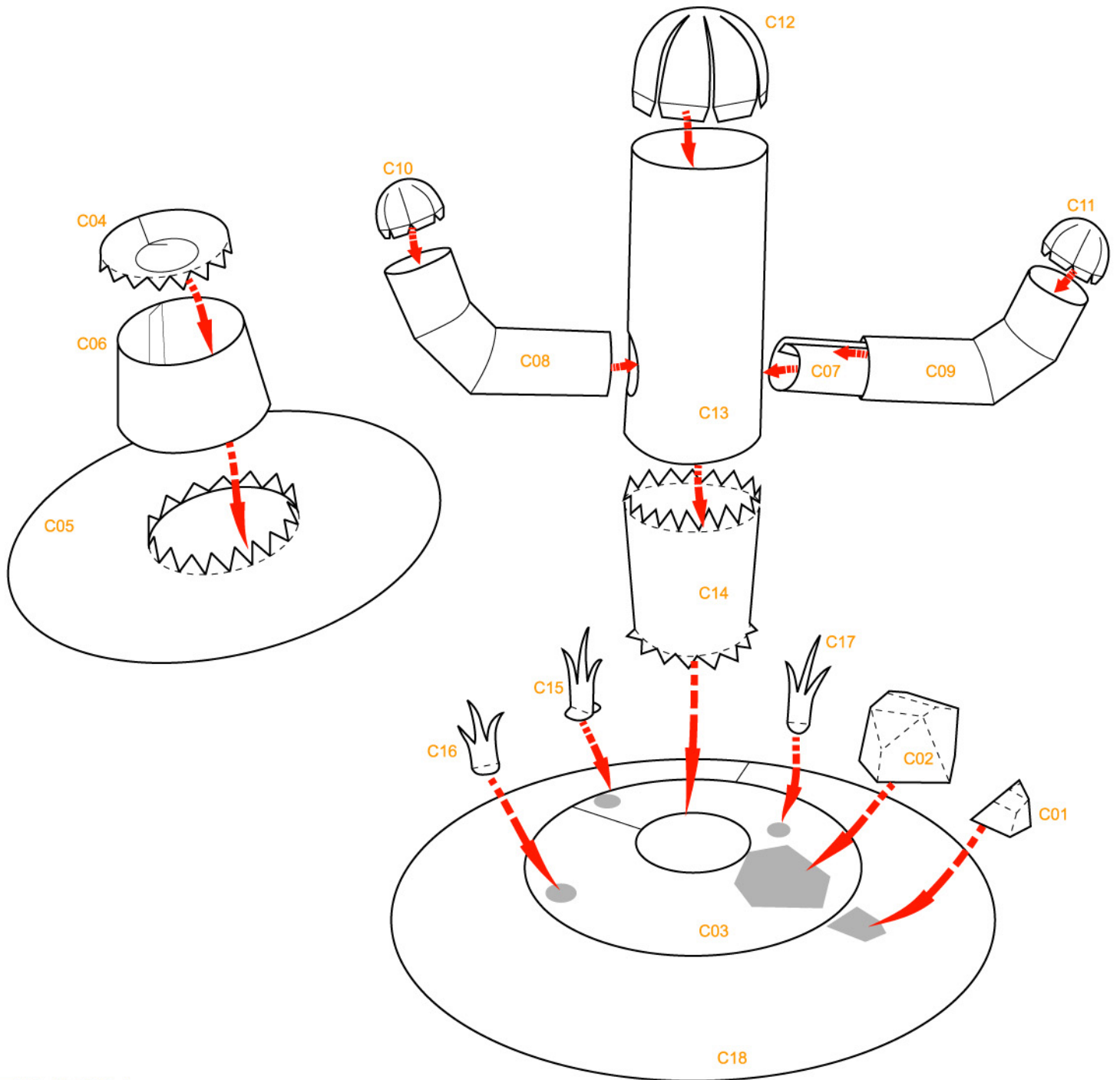



### Instructions



1 Separate all parts along the lines. Mark their identity on the back to avoid confusion.

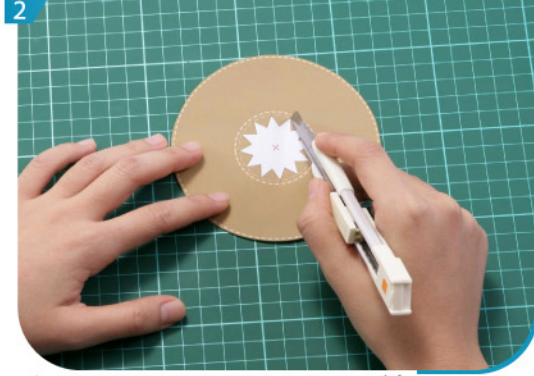

2 Cut out parts which are marked with an 'x'.



3 Use a pen whose ink has dried out, or a tracer, to trace lines first.



4 Fold all parts along the lines.



5 Fold and glue C01 and C02 separately to form small stones.

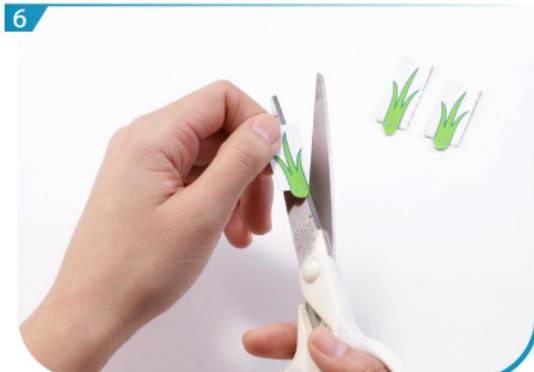

6 Fold and glue C15, C16 and C17 separately. Cut each part into grass.



7 Fold and glue C03 and C18 separately. Then glue these two parts to form a base.



8 Glue small stones and grass on the base at random.

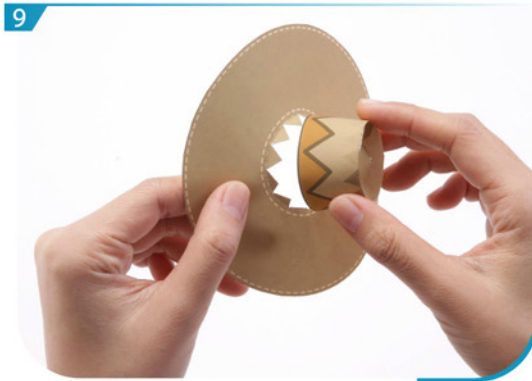

9  
Fold and glue C04, C05 and C06 separately. Then assemble these parts into a hat.

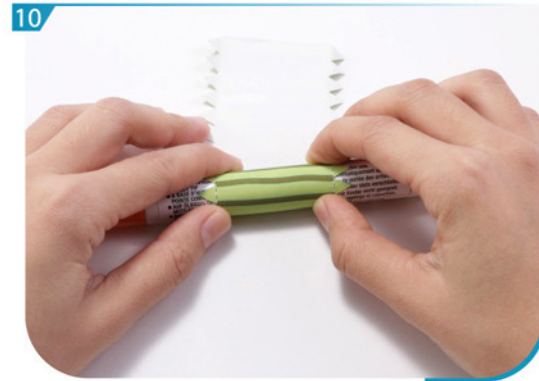

10  
Use a cylindrical pen to roll C7, C8, C9, C13 and C14.



11  
Glue the above parts respectively.



12  
Assemble C10, C11 and C12 with C8, C9 and C13 respectively according to the assembly instructions. Put C07 into C09, then slip it into C08 through C13, and glue C14 to C13 to complete your cactus.



13  
Finally, glue the base to the cactus and you have a desert cactus made all by yourself.